

# *TRESU Pinta*

*Inline coating solution*

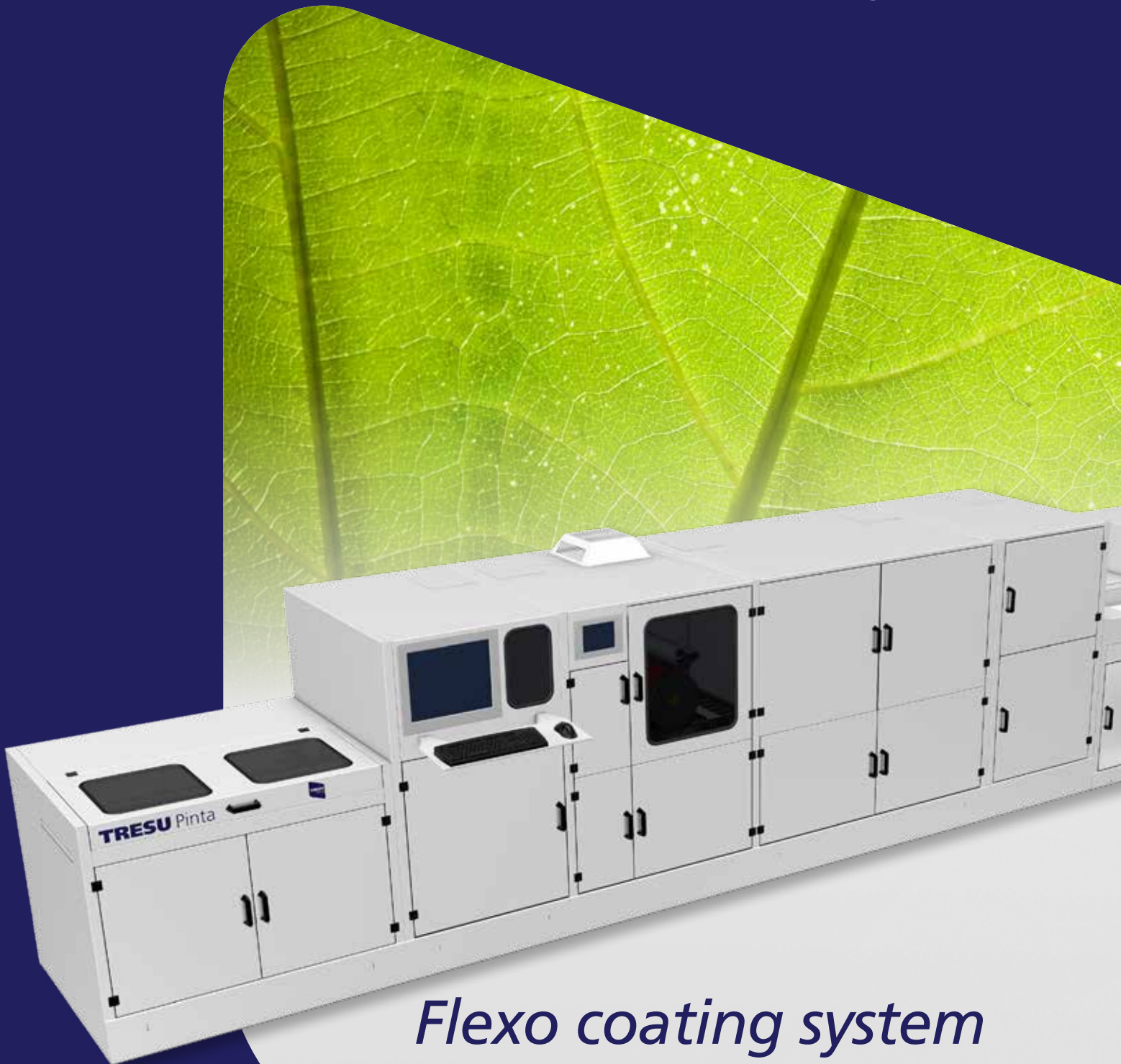

*Flexo coating system  
for full surface or  
selective coating*

# Inline coating solution for the Xerox **TRESU** Pinta

**TRESU Pinta** is an innovative, inline coating solution for digital sheetfed folding carton production. It is 100% modular and designed for perfect integration with the Xerox iGen™ series of presses.

**TRESU Pinta** offers **state-of-the-art coating**. Both water-based and UV varnishes can be used for a wide range of applications, including pharmaceutical, media, food and confectionery, cosmetics, consumer electronics, promotional, gifts, and more.

The **TRESU Pinta** and **Xerox iGen™** press offer a **complete digital printing folding carton production line** – for printing, full surface or selective coating and stacking.

With a flexible, and quick sleeve-change process, **changeover is possible in less than 5 minutes**, enabling production of any size job from very small batches to large-scale production.

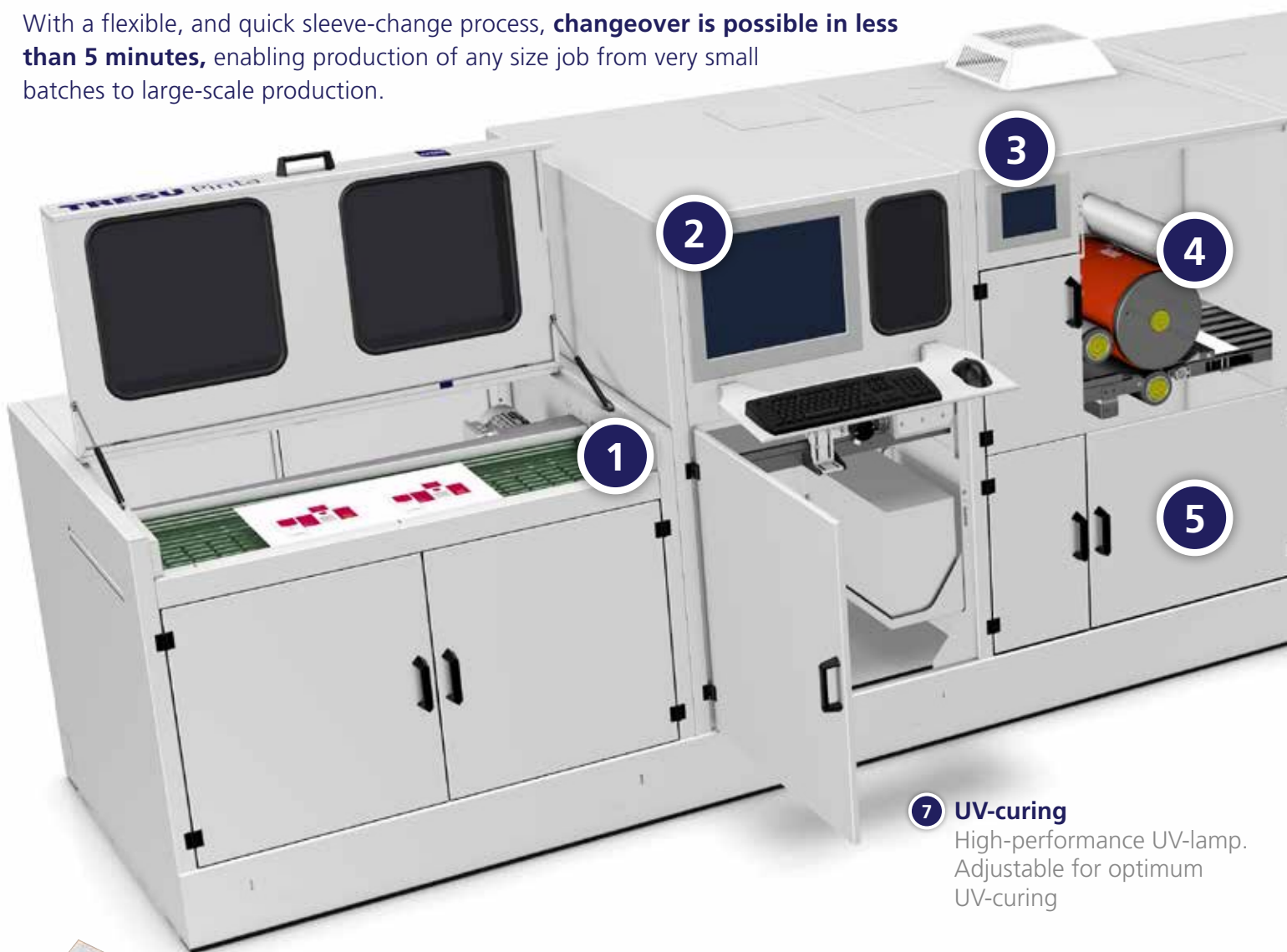

- 7 **UV-curing**  
High-performance UV-lamp.  
Adjustable for optimum  
UV-curing



Liquid  
Food Service  
Graphical  
Food  
Pharmaceutical



# iGen™ series of presses

**1 Alignment table**  
For high register alignment of the digital printed sheets

**2 Image inspection**  
Optional images inspection system, approved for pharmaceuticals

**3 User interface**  
Easy-to-operate user interface. The entire line, including stacker, can be operated by one person



**4 Flexo coating system**  
For full surface or selective coating. Sleeve-based quick-change system

**5 Pumping system**  
Easy-to-operate coating supply system

**6 Hot air drying**  
Efficient hot air drying system for water-based coating

**8 Sample tray**  
Sheet output during production. For visual inspection and test samples

**9 Stacker**  
Integrated stacker with buffer for continuous production

**10 Conveyor**  
Optional for inline production with die-cutter



**Cosmetics  
& Luxury  
Chocolate  
Beverage  
& Multipack**







## Technical Data

<b>Definition</b>	<b>Coating unit with sleeve technology</b>	
<b>Dimensions/</b> Width x Height x Depth. <b>Weight</b>	<b>W6025 x H1667 x D1200 mm. Weight 3000 kg</b>	
<b>Sheet size</b>	<b>Min.</b> 420 x 290 mm (16.54"x 11.42") <b>Max.</b> 660 x 364 mm (25.98"x 14.33")	
<b>Image size</b>	<b>Max.</b> 650 x 360 - (25.59"x 14.17")	
<b>Substrate range</b>	Thickness:	200 - 600 $\mu$ (8 pt - 24pt)
	Weight:	190 - 500 g/m <sup>2</sup>
<b>General coating requirements</b>		
<b>Coating method</b>	Full surface and selective coating	
<b>Varnish type</b>	UV and WB including blister	
<b>Varnish gloss level</b>	UV - gloss and matte WB - gloss and matte	
<b>Speed</b>	3000 sheets/hour. Adapted to Xerox iGen™ print engine	
<b>Cleaning</b>	Automatic:	Blanket cleaning during production with water-based coating
	Intensive:	Between setup changes
<b>Sleeve change</b>	Setup time < 5 min	
<b>User interface</b>	Operator friendly user interface	
<b>Sheet tray</b>	Integrated sheet/sample tray	
<b>Stacker</b>	Buffering stacker for continuous production	
<b>Optional</b>		
<b>Image inspection system</b>	Approved for pharmaceuticals	
<b>Advanced registration alignment</b>	Registration mark detection	

### TRESU Group

14-16, Eegsvej  
DK-6091 Bjert  
Denmark  
Tel: +45 76 32 35 00  
Mail: tresu@tresu.com  
[www.tresu.com](http://www.tresu.com)

### TRESU GmbH

Giftener Str. 9A  
31157 Sarstedt  
Germany  
Tel: +49 5066 9174286  
Mail: aju@tresu.de

### TRESU Italia s.r.l

Via delle Groane  
27/b20024  
Garbagnate Milanese (MI)  
Italy  
Tel: +39 02 96 59 202  
Mail: tresu@tresu.it

### TRESU Japan Co., Ltd.

8-1-32, Nanko Naka  
Suminoe-ku  
Osaka, 559-0033  
Japan  
Tel: +81 6 4703 0601  
Mail: sales@tresu.jp

### TRESU China

Huashang Building, Room 613  
No. 2 Yanjing Xili  
Chaoyang District  
100025 Beijing  
China  
Tel: +86 (0) 10 65911628  
Mail: sales@tresu.cn

### TRESU Americas

TRESU Royse, Inc.  
8517 Directors Row  
Dallas, TX 75247  
USA  
Tel: +1 214 631 2844  
Mail: tresu-royse@tresu.com

Cosmetics &  
Luxury

Liquid

Chocolate

Food Service

Beverage &  
Multipack

Graphical

Food

Pharmaceutical



*The Best Part of Innovation*